

Features

- Bi-polar (Radial)
- Ideal for inconsistent polarity circuits
- For the compaction of equipment
- load life of 1000 hours at 85°C

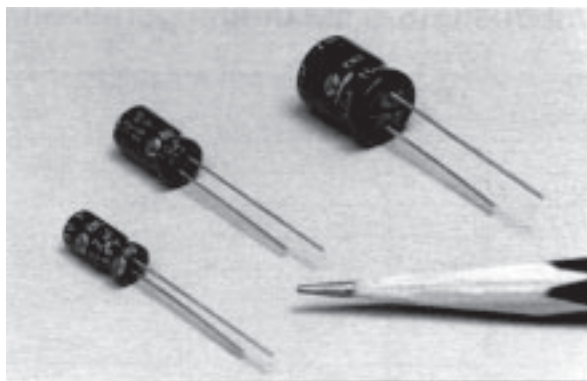

Specifications

Item	Performance Characteristics				
Operating temperature range	-40°C ~ +85°C				
Rated working voltage range	10V ~ 50V				
Nominal capacitance range	0.47 μF ~ 1000 μF, ±20%(at 20°C, 120Hz)				
D.C Leakage current(at 20°C)	The following specifications shall be satisfied when the rated voltage is applied for the required time. $I \leq 0.03CV + 3 \mu A(3 \text{ min})$ Where I=Leakage current(μA) C=Nominal capacitance(μF) V=Rated voltage (V)				
Tan δ (max., at 20°C, 120Hz)	W.V(V)	10	16	25	50
	Tan δ	0.25	0.20	0.17	0.15
Characteristics at low temperature(max.) (impedance ratio at 120Hz)	W.V(V)	10	16	25	50
	Z-25°C/Z20°C	3	2	2	2
Load life	Z-40°C/Z20°C	8	6	4	3
	After applying rated working voltage for 1000 hours at +85°C with the polarity inverted every 250 hours and then being stabilized at +20°C, capacitors shall meet following limits.				
Shelf life	Capacitance change	Within ± 20% of initial measured value			
	Tan δ	≤ 150% of initial specified value			
	Leakage current	≤ Initial specified value			
Shelf life	After storage for 500 hours at +85°C with no voltage applied and then being stabilized at +20°C, capacitors shall meet following limits.				
	Capacitance change	Within ± 20% of initial measured value			
	Tan δ	≤ 150% of initial specified value			
	Leakage current	≤ 200% of initial specified value			

Case sizes and Dimensions

Dimensions & Maximum permissible ripple current [mA(rms) at 85°C, 120Hz]

øD x L(mm)

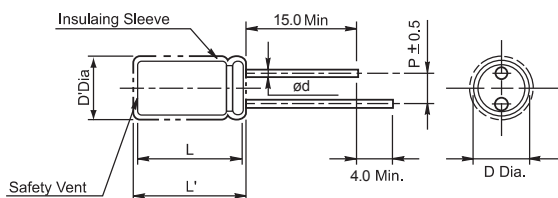

• Standard lead style

øD	5.0	6.3	8.0	10.0	13.0	16.0
p	2.0	2.5	3.5	5.0		7.5
ød	0.5		0.6			0.8

 $D' = [D+0.5] \text{Max.}$
 $L' = [L+1.0] \text{Max. at } D \leq 8.0$
 $L' = [L+1.5] \text{Max. at } D \geq 10.0$

W.V Cap(μF)	10(1A)		16(1C)		25(1E)		50(1H)	
	SIZE	I _R	SIZE	I _R	SIZE	I _R	SIZE	I _R
0.47							5 x 11	10
1.0							5 x 11	16
2.2							5 x 11	26
3.3							5 x 11	33
4.7					5 x 11	27	63 x 11	42
10					5 x 11	50	8 x 115	70
22	5 x 11	62	63 x 11	75	63 x 11	90	10 x 125	120
33	63 x 11	82	63 x 11	100	8 x 115	115	10 x 16	160
47	63 x 11	105	8 x 115	125	10 x 125	150	10 x 20	200
100	8 x 115	165	10 x 125	200	10 x 16	260	13 x 20	340
220	10 x 16	270	10 x 20	340	13 x 20	420		
330	10 x 20	340	13 x 20	430				
470	13 x 20	440	13 x 25	550				
1000	16 x 25	700	16 x 25	900				

ORDERING INFORMATION for Leaded Type



Daewoo Components Corp.

Through-Hole Part Numbering System Example:

RM = Leaded Radial 85°C Miniature Series, **102** = 1000µF, **M** =20% Tolerance, **1E** 25 Volts, **B** = Bulk,
1020 = Case size (Dia x H) = 10.0 x 20.0mm, **E** = 5.0mm

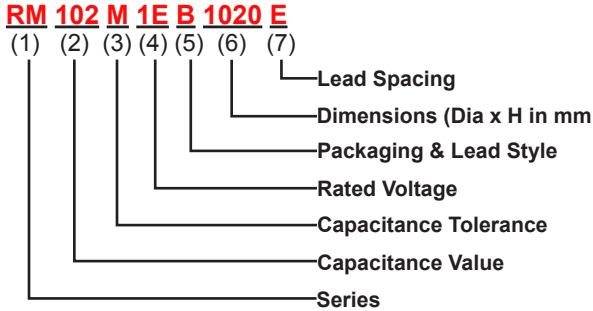

(1) Series

See Quick Guide on page 2
Example: RSS, RM, RMU,...

(2) Capacitance Value Code

Capacitance expressed in micro Farads (µF)
First two digits are significant figures
Third digit denotes the number of zeros
Use R for decimal point for values less than 10µF

Examples:

CODE	Capacitance
R10	0.1 µF
R68	0.68 µF
1R0	1.0 µF
100	10 µF
680	68 µF
471	470 µF
102	1000 µF
103	10000 µF

(3) Capacitance Tolerance Code

CODE	Cap. Tol.	CODE	Cap. Tol.
J	±5%	V	-10% ~ +20%
K	±10%	Q	-10% ~ +30%
M	±20%	T	-10% ~ +50%
R	+20%, -0%		

(4) Rated Voltage Code

CODE	Voltage	CODE	Voltage
0G	4.0V	2C	160V
0J	6.3V	2S	180V
1A	10V	2D	200V
1C	16V	2E	250V
1E	25V	2F	315V
1V	35V	2V	350V
1H	50V	2G	400V
1J	63V	2W	450V
1K	80V	3Z	1000V
2A	100V		

(5) Packaging Form & Lead Style Code (see page 7, 8, 9 for details)

	Code	Packaging Form & Lead Style
Bulk	B	Bulk: Standard Package
	L	Bulk: 4 -8ø Long Leads Formed to 5 mm Pitch
Snap-In	1	10-13ø Snap-in Cut 5.0mm
	2	16-13ø Snap-in Cut 5.0mm
	3	10-13ø Snap-in Cut 4.5mm
	4	16-18ø Snap-in Cut 4.5mm
	5	4-8ø Snap-in Cut 7.5mm
Form	F	4-8ø Forming Cut 6.5mm
	G	4-8ø Forming Cut 10.0mm
Straight Cut	C	4-18ø Straight Cut 4.0mm
	6	4-18ø Straight Cut 3.1mm
	7	4-18ø Straight Cut 5.0mm
	8	4-18ø Straight Cut 6.35mm
Ammo Tape (+) Leading	A	4-8ø Straight Ammo
		Detail Ranges: 4-6.3ø; F=2.5mm 8ø; F=3.5mm
		4-8ø Form Tape & Ammo 5mm Pitch
		10ø Straight Ammo Tape 5mm Pitch
		13ø Straight Ammo Tape 5mm Pitch
16-18ø Straight Ammo Tape 5mm Pitch		
Tape & Reel (+) Leading	T	4-8ø Straight Ammo
		Detail Ranges: 4-6.3ø; F=2.5mm 8ø; F=3.5mm
		4-13ø Form Tape & Reel 5mm Pitch 10-13ø Straight Reel Tape 5mm Pitch

NOTE: Standard Pack Anode(+) Lead Leading FEEDS OFF FIRST
Special Option Cathode(-) Lead Leading available upon request
Standard Packages: B = Bulk, A = Ammo, T = Tape & Reel

(6) Example Dimension Code (Diameter x Height in mm)

Size Code	Diameter	Height	Size Code	Diameter	Height
0405	4	5	1320	13	20
0407	4	7	1631	16	31.5
0505	5	5	1835	18	35.5
0507	5	7	2240	22	40
0607	6.3	7	2545	25	45
0511	5	11	3035	30	35
0605	6	5	3500	35	100
0611	6.3	11	3501	35	110
0805	8	5	5102	51	120
0811	8	11	6303	63.5	130
1012	10	12.5	7604	76	140
1220	12.5	20	8904	89	140

(7) Lead Spacing Code (LS)

Code	X	A	B	C	D	E	J	F
LS	1.0	1.5	2.0	2.5	3.5	5.0	7.0	7.5
Code	K	M	G	P	H	Q	R	S
LS	8.0	10.0	10.5	12.0	12.5	12.8	15.0	16.0
Code	T	U	V	W	Y	Z		
LS	20.0	21.7	28.3	30.0	31.6	32		